

FENDER FLARE INSTALLATION INSTRUCTION GMC SIERRA 14-UP FULL SIZE CREW CAB 5.8' BED

Parts

Qty (1) Fender Flare Left Front (LF)
Qty (1) Fender Flare Left Rear (LR)
Qty (1) Fender Flare Right Front (RF)
Qty (1) Fender Flare Right Rear (RR)
Qty (1) Rubber Seal (enough for four flare's outer edge)

Qty (8) Flange Type-A Screw
Qty (14) Truss Type-A Screw & Washer
Qty (40) Allen Bolt & Nut (Torx Bit required)
Qty (8) Self Tapping Screws
(see **option B**)

Step 1. Pre-Installation

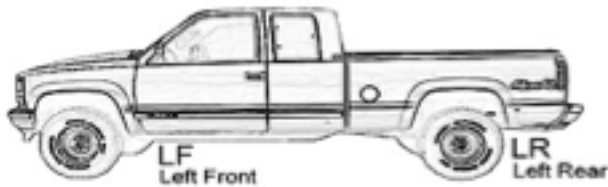

Prefit and ensure both driver and passenger side fender flares to the vehicle before painting or installation. You may remove any moldings, strips or extension flares from the vehicle for fitting or installation.

Step 2. Painting (optional)

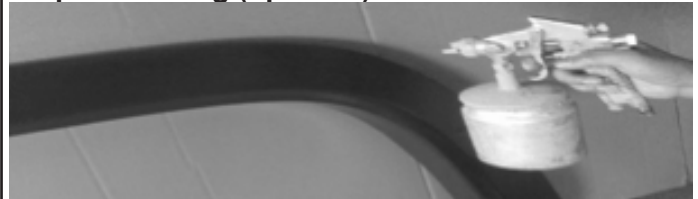

Professional paint or body shop recommended to paint flares. Follow all the paint manufacture specifications to paint the flares. Clean fender flare surfaces with clean water and a mild detergent before painting, do not use lacquer thinner or any solvent based products.

Step 3. Cleaning

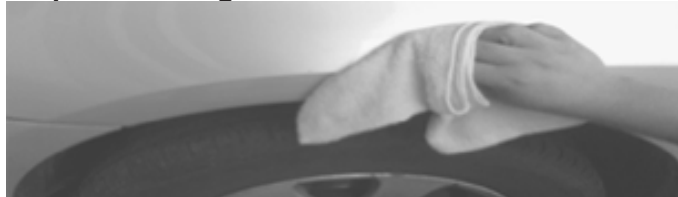

Wash and wipe dry the areas of contact on the vehicle body. Clean the surface and inside edge of the fender flare where the rubber seal is to be attached.

Step 4. Apply Rubber Seal

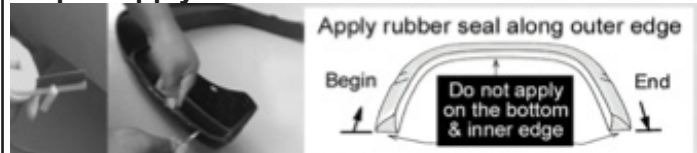

Remove about 1 inch tape liner from rubber seal and apply it on the flare, start one end and along the edge that comes in contact with the body panel, apply pressure on the tape to ensure that it adheres well. Trim excess rubber seal and so on.

Step 5. Installation (Left Front Flare Shown)



Make sure the front tire has been turned outward for easy installation.
FOR MODELS WITH FACTORY MUDFLAP
Remove 5 mudflap fasteners with T-30, T-15 torx bit & screwdriver. Save the upper two fasteners for re-install in step 7.

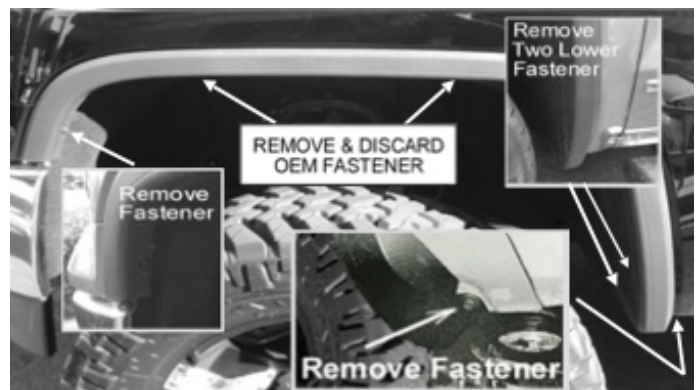

Use a 9/32" or 7mm socket to remove the fastener on the front of factory wheel arch molding (left shown). Use a T-15 Torx Bit to remove two lower fasteners on the rear of the factory wheel arch molding (right top shown). Use a 1/2" socket to remove fastener from the rear underside of factory wheel arch molding. Save and reinstallation. Use a T-15 Torx Bit to remove two fasteners along the top of the factory wheel arch molding (center top shown).

Step 5. (Continued)

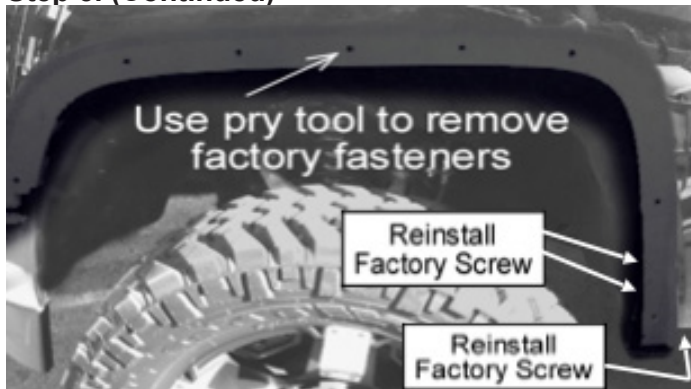

Pull the lower grip part to remove the factory flare from the vehicle. Use pry tool to remove any remaining factory fasteners.

FOR MODELS WITH FACTORY MUDFLAP

Re-install the upper two fasteners. Use a 1/2" socket to re-install fastener from the rear underside of factory wheel arch molding.



Use Torx Bit to tight allen bolt & nylon nut firmly on every pocket of the fender flares. **DO NOT OVER TIGHTEN!** Hold the flare firmly on the fender, to confirm the right position.

FOR MODELS WITHOUT FACTORY MUDFLAP

Make sure other holes are on the position, use a grease pencil to mark a hole through the upper rear hole on the flare, as shown. Remove the flare. Drill a hole on the marked location through wheel well liner and sheet metal with a 3/32" drill bit.

Step 6. Installation (Left Rear Flare Shown)

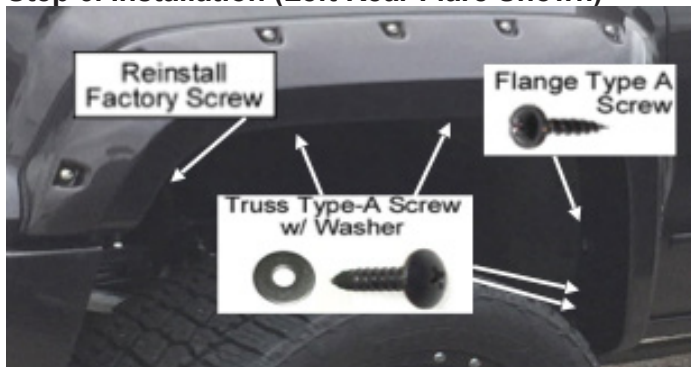

Install 4 supplied truss type A screws into the factory holes. Re-install the factory screw. Install 1 supplied flange type A screw into the hole drilled.

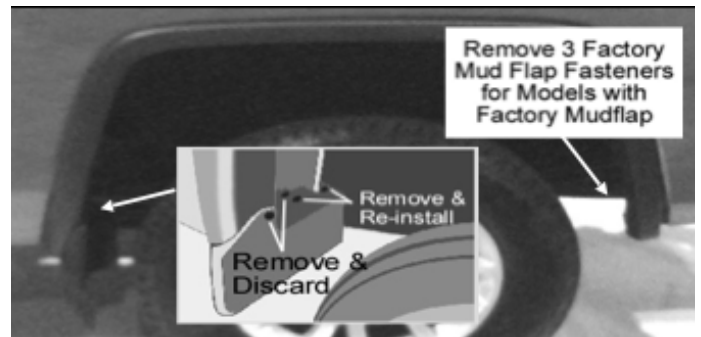

Remove 4 factory screws from the factory wheel well piece and remove. Re-install 2 factory screws into wheel well liner, as left shown.

FOR MODELS WITH FACTORY MUDFLAP

Remove 3 mudflap fasteners with screw driver.

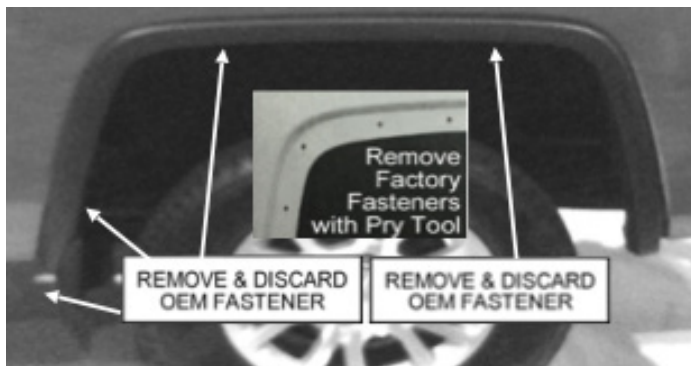

Use a 10mm socket to remove the lower 2 screws. Use T-15 Torx Bit to remove the other 3 fasteners. Use pry tool to remove and remaining factory fasteners. Pull the lower grip part to remove the factory flare from vehicle



Use Torx Bit to tight allen bolt & nylon nut firmly on every pocket of the fender flares. **DO NOT OVER TIGHTEN!** Hold the flare firmly on the fender, to confirm the right position. Make sure other holes are on the position, use a grease pencil to mark 3 holes through the holes on the flare, as shown. Remove the flare.

Step 6. (Continued)

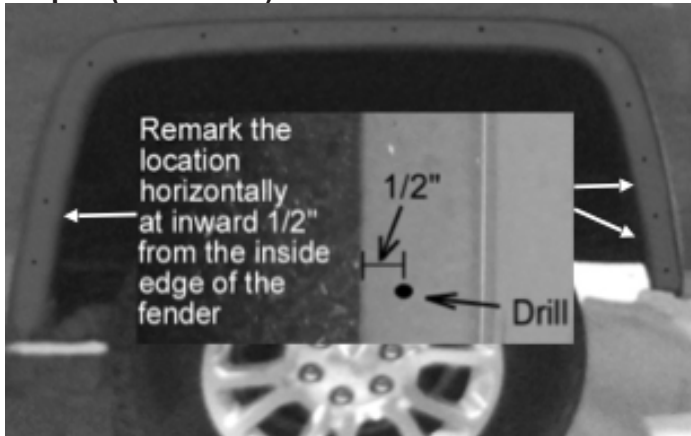

Remark the 3 locations horizontally at inward 1/2" from the inside edge of the fender. Drill a hole on the marked locations through sheet metal with a 3/32" drill bit. (Use a floor jack on the rear hitch to raise the truck bed for easy to drill.)

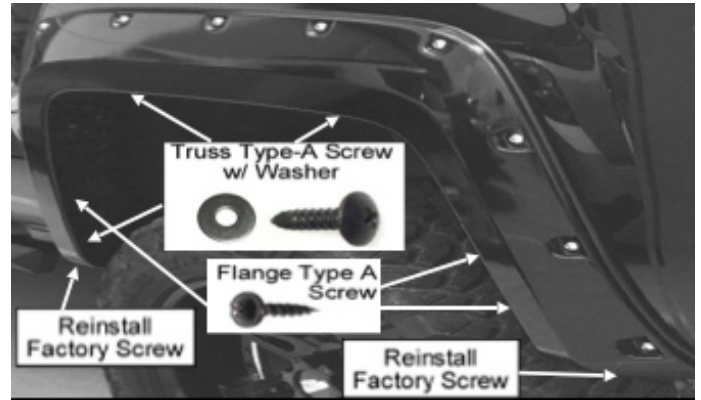

Install 3 supplied truss type A screws into the factory holes. Re-install the 2 factory screws underside. Install 3 supplied flange type A screws into the holes drilled.

Option B: If condition of fender prevents use of the Clips you can use the included self tapping screws to secure the flare to the fender.