

FENDER FLARE INSTALLATION INSTRUCTION DODGE RAM 02-05.06-09 FULL SIZE ONLY

Parts

Qty (1) Fender Flare Left Front (LF)
Qty (1) Fender Flare Left Rear (LR)
Qty (1) Fender Flare Right Front (RF)
Qty (1) Fender Flare Right Rear (RR)

Qty (1) Rubber Seal (enough for four flares's outer edge)
Qty (10) Push-In Clip
Qty (4) Plastic Expanding Fastener
Qty (38) Allen Bolt & Nut (Torx Bit required)
Qty (8) Self Tapping Screws (see **option B**)

Step 1. Pre-Installation



Pre-fit both driver side and passenger side fender flares to the vehicle before painting or installation. You may remove any moldings, strips or existing flares from the vehicle for fitting or installation. You can cut the fender flare to fit any body side molding.

Step 2. Painting (optional)



Professional paint or body shop recommended to paint flares. Follow all the paint manufacture specifications to paint the flares. Clean fender flare surfaces with clean water and a mild detergent before painting, do not use lacquer thinner or any solvent based products.

Step 3. Cleaning



Wash and wipe dry the areas of contact on the vehicle body. Clean the surface and inside edge of the fender flare where the rubber seal is to be attached.

Step 4. Apply Rubber Seal



Remove about 1 inch of tape liner from rubber seal and apply it to the flare. Start at one end of the flare along the edge that comes in contact with the body panel. Apply pressure on the tape to ensure adhesion, and trim excess rubber seal at the end.

Step 5. Installation (Left Front Flare Shown)



Use torx bit to tighten allen bolt & put firmly on every pocket of the fender flares first. Place the flare on the vehicle. Apply 2 Push-In Clips into the mounting slots in the flare and secure it to the vehicle as shown. Fasten the existing factory screws into the original location that were previously removed.

Step 6. Installation (Left Rear Flare Shown)

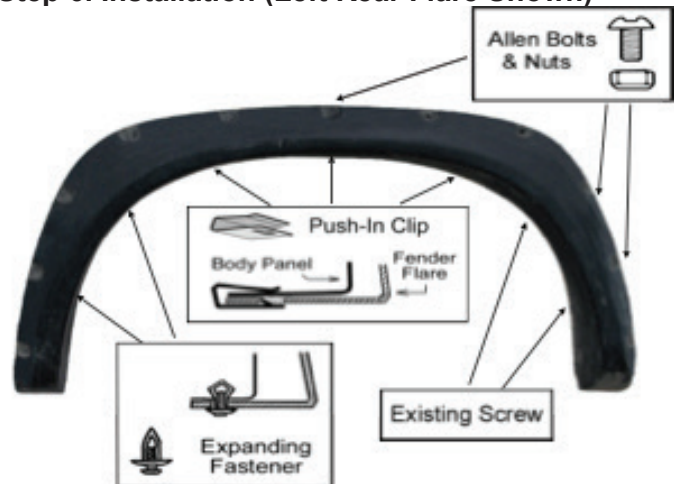

Use torx bit to tighten allen bolt & put firmly on every pocket of the fender flares first. Place the flare on the vehicle. Apply 3 Push-In Clips into the mounting slots in the flare and secure it to the vehicle. Apply 2 Plastic Expanding Fasteners into the mounting slots in the flare and secure it to the vehicle as shown. Fasten the existing factory screws into the original location what were previously removed.

Option B: If condition of fender prevents use of Push-In Clips you can use the included self tapping screws to secure the flare to the fender.

855-787-8334

www.trueedgeproducts.com