

FENDER FLARE INSTALLATION INSTRUCTION

NISSAN TITAN 16-UP

Item No. FLZ209713 (Rivetz Style)

- Qty (1) Fender Flare Left Front & Inner Bracket (LF)
- Qty (1) Fender Flare Left Rear (LR)
- Qty (1) Fender Flare Right Front & Inner Bracket (RF)
- Qty (1) Fender Flare Right Rear (RR)
- Qty (1) Rubber Seal (enough for four flares's outer edge)

Parts

- Qty (33) Allen Bolt, Nut & Washer (Hex Key or Torx Bitr required)
- Qty (2) U-Clip & Flange Screw
- Qty (6) Long Clip & Truss Screws
- Qty (2) Plastic Fasteners
- Qty (14) Truss Type-A Screw & Washers
- Qty (8) Self Tapping Screws (Optional B)

Step 1. Pre-Installation

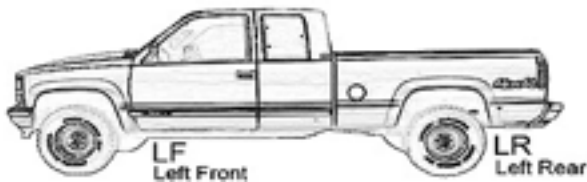

Prefit and ensure both left (driver) side & right (passenger) side fender flare to the vehicle before painting or installation. You may remove any moldings, strips or existing flares from the vehicle for fitting and installation.

Step 2. Painting (optional)

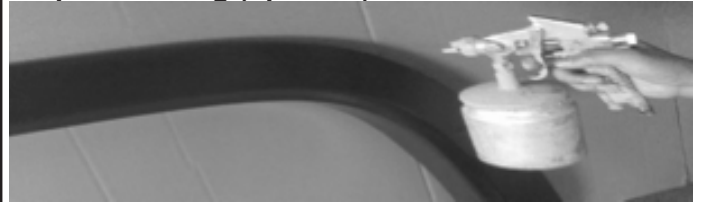

Hire a professional painter or body shop and follow the paint manufacturer specifications to paint the flares. Clean all fender flare surface with clean water & a mild detergent before paint, don't use lacquer thinner or any solvent based product.

Step 3. Cleaning



Wash and wipe dry the areas of contact on the vehicle body. Clean the surface and inside edge of the fender flare where the rubber seal is to be attached.

Step 4. Apply Rubber Seal



Remove 1 inch tape liner from rubber seal, apply it on the flare, start one end & along the edge that comes in contact with body panel.
Caution: 3M tape will stick on the inside of the flare. Make sure the rubber seal along the edge well, and rip the tape liner off gradually, apply pressure on the tape in the same time to ensure that it adheres well. Trim excess rubber seal and so on.

Step 5. Installation (Left Front Shown)

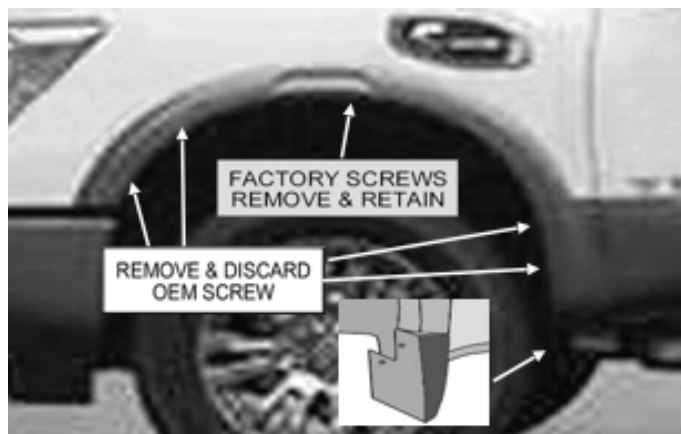

Remove five existing factory screws, save one screw on top center for reinstallation, remove the flare, as shown. Remove factory mud flaps if installed.

Step 6. Installation (Left Front Shown)

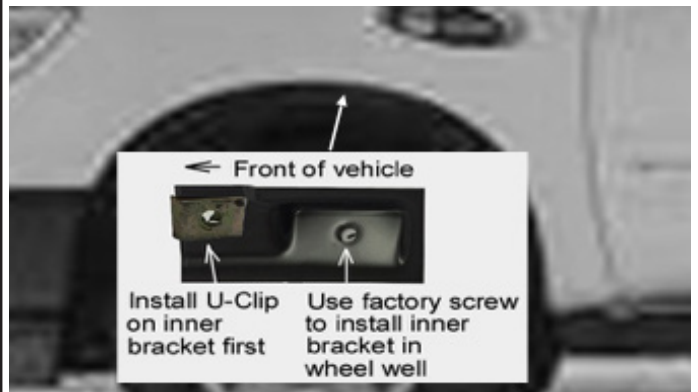

Ensure to have the right inner bracket & knowing the way to install. Install a U-Clip over the hole on the inner bracket first. Install a factory screw through bracket and into factory uppermost hole on the fender wheel well.

7. Installation (Left Front Shown)

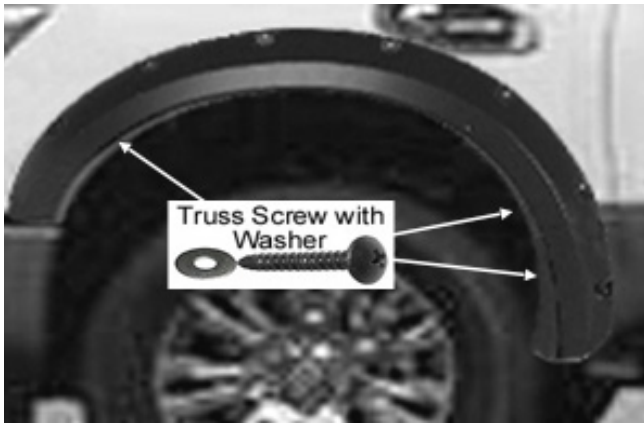

Apply three Truss Type-A Screws through flare into factory holes.

8. Installation (Left Front Shown)

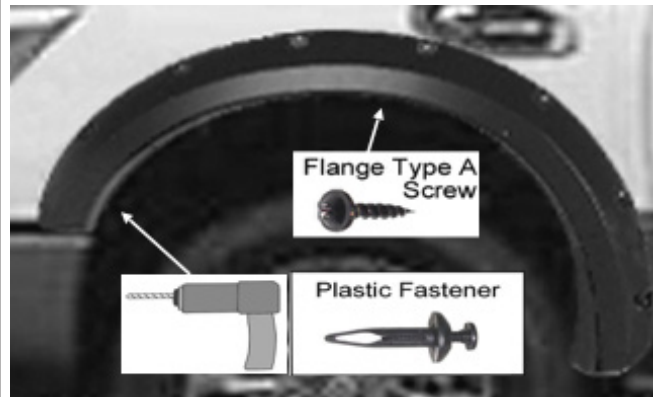

Apply one Flange Screw through inner piece, into U-Clip and secure it to the vehicle on the uppermost hole, as shown. Push the front fender flare to ensure it contact with the fender well, drill a 1/4" hole through the hole on the flare into the wheel well. Secure the flare with a plastic fastener into the hole.

9. Installation (Left Rear Flare Shown)

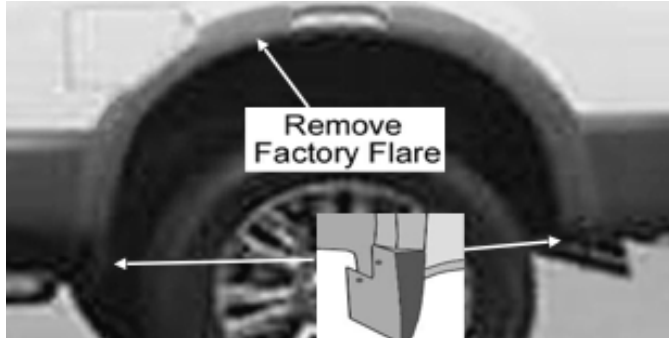

Remove all existing factory screws, and remove the flare. Remove factory mud flaps if installed.

10. Installation (Left Rear Shown)



Remove three factory clips on the top center.

11. Installation (Left Rear Flare Shown)



Install three long clips over the original factory clip location that were previously removed, as shown.

12. Installation (Left Rear Shown)

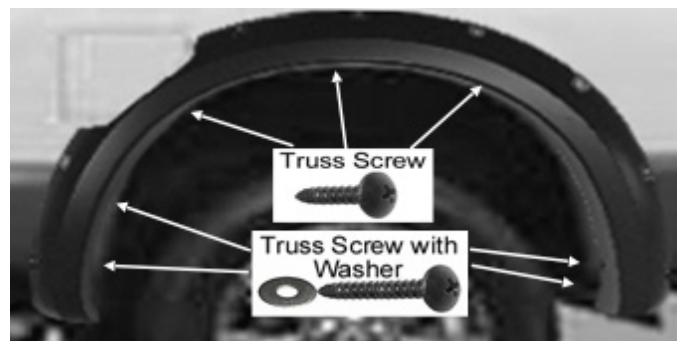

Secure the flare with three Truss Type screws into the long clip. Apply four Truss Type-A Screws through the flare into the factory holes. Tighten all screws.

Optional B: The included self tapping screw may be used for extra secure if needed.